



6-CNJ-220

12V220Ah

Edition:2016.6
By Frank

**FUWEI
ENERGY**

<http://www.fwny.net/en/>

Component	Positive plate	Negative	Container	Cover	Safety Valve	Terminal	Separator	Electrolyte
Raw Material	Lead dioxide	Lead	ABS	ABS	Rubber	Copper	AGM	GEL

To get the most out of your eco-friendly renewable energy system for home, RV or back-up power, you need a rugged, long-lasting solar photovoltaic (solar PV) battery from FUWEI energy. A high-capacity solar battery is perfect for backup systems, off-grid configurations and other applications that call for deep-cycle storage. Choose from absorbed glass mat (AGM) and gel-cell batteries for all your solar application needs.

Performance characteristics
Nominal Voltage 12V
Number of cell Six
Nominal Capacity at 25 °C/77 °F
 240Hr at 1.11 A to 1.9V-- 267 Ah
 100Hr at 2.57 A to 1.85V-- 257 Ah
 10Hr at 22 A to 1.8V-- 220 Ah
Internal Resistance
 Fully charged battery at 25 °C
 $\leq 3.5 \text{ m}\Omega$
Average Self-discharge at 20 °C/68 °F
 <3% lost of capacity per month
Operating Temperature range:
 Discharge at -40~70 °C
 Charge at -10~60 °C
 Storage at -20~60 °C
Charge Methods constant voltage charge at 25 °C
 Cycle use--2.4~2.45V/cell;
 Maximum initial charging current 24 A
 Temperature compensation
 -5mV/cell/ °C

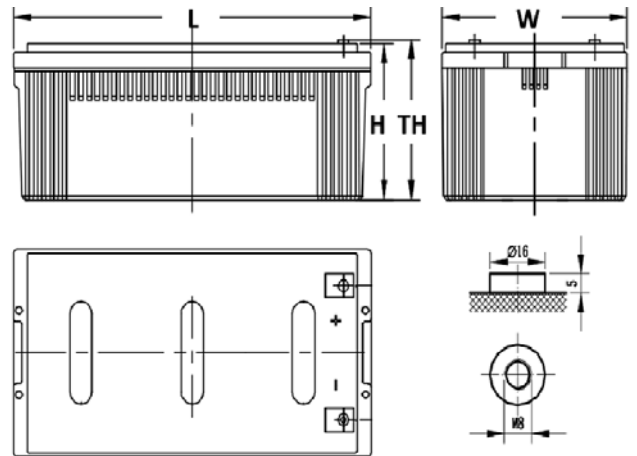

	mm/Kg	inch/lb
Length	522	20.6
Width	269	10.6
Height	220	8.66
TH	245	9.65
Weight	62	137
Terminal	M8	Copper





**FUWEI
ENERGY**

6-CNJ-220

12V220Ah

<http://www.fwny.net/en/>

Constant Power discharge / WPC (25°C/77°F)

End voltage/cell	3 h	5 h	10 h	20 h	50 h	100 h	120 h	240 h
1.75V	55.9	37.8	39.9	19.0	8.29	3.87	3.45	1.83
1.80V	53.7	36.9	39.5	18.8	8.21	3.86	3.41	1.79
1.85V	51.5	35.4	38.1	18.2	7.92	3.74	3.29	1.74
1.90V	49.5	34.0	36.9	17.5	7.67	3.64	3.17	1.67

Constant current discharge / A (25°C/77°F)

End voltage/cell	3 h	5 h	10 h	20 h	50 h	100 h	120 h	240 h
1.75V	100	67.5	22.3	10.6	5.31	2.73	2.32	1.22
1.80V	96.4	66.1	22.0	10.5	5.21	2.68	2.28	1.20
1.85V	92.8	63.5	21.1	10.0	5.01	2.57	2.19	1.16
1.90V	89.9	61.2	20.2	9.64	4.81	2.48	2.10	1.11

Note: The above characteristics data are average values obtained within three charge/discharge cycles not the minimum

All data shall be changed without notice. FUWEI reserves the right to explain and update the information contained hereinto

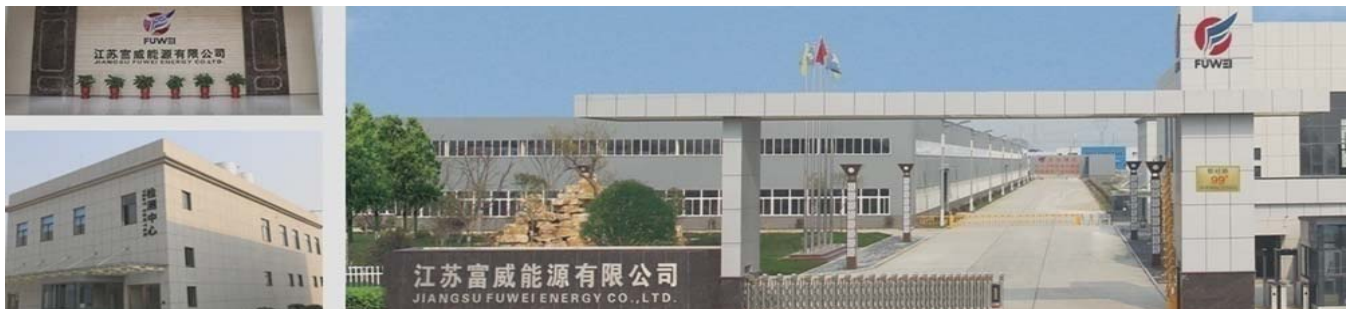

Application

- Telecom Systems
- Electric Wheelchair
- Solar System
- Marine Equipment
- Wind Power System
- Emergency Power System
- Wheelchair

General Features

- Environmentally friendly
- Long Service Life, in Cyclic
- Lower internal Resistance
- High Reliability and Good Quality
- International Standard, JIS and DIN
- High Power Density
- lead-tin-calcium alloy grids for long service life
- Thick pasted plates with high quality

JIANGSU FUWEI Energy CO.,LTD.

Quality Achievement Brand Build Our Future



6-CNJ-220

12V220Ah

FUWEI
ENERGY

<http://www.fwny.net/en/>

