



6-CNJ-250

12V250Ah

FUWEI

ENERGY

Component	Positive plate	Negative	Container	Cover	Safety Valve	Terminal	Separator	Electrolyte
Raw Material	Lead dioxide	Lead	ABS	ABS	Rubber	Copper	AGM	GEL

Performance characteristics

Nominal Voltage 12V

Number of cell Six

Nominal Capacity at 25 °C/77 °F

10Hr at 25 A to 10.8V-- 250 Ah

5Hr at 43 A to 10.5V-- 215 Ah

1Hr at 165 A to 9.6V-- 165 Ah

Internal Resistance

Fully charged battery at 25 °C

≤ 3.5 mΩ

Average Self-discharge at 20 °C/68 °F

<3% lost of capacity per month

Operating Temperature range:

Discharge at -20~60 °C

Charge at -10~60 °C

Storage at -20~60 °C

Max. discharge current at 25 °C: 3750 A(5s)

Charge Methods constant voltage charge at 25 °C

Cycle use---2.4~2.45V/cell;

Maximum initial charging current 75 A

Temperature compensation

-5mV/cell/ °C

Standby use---2.25~2.30V/cell

Temperature compensation

-3mV/cell/ °C

	Length	Width	Height	Total H	Weight	Terminal
mm/Kg	522	269	220	244	68	F12
inch/lb	20.6	10.59	8.66	9.61	150	M8

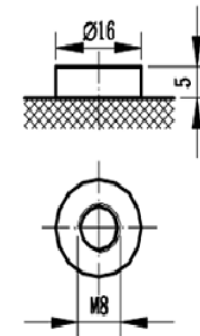
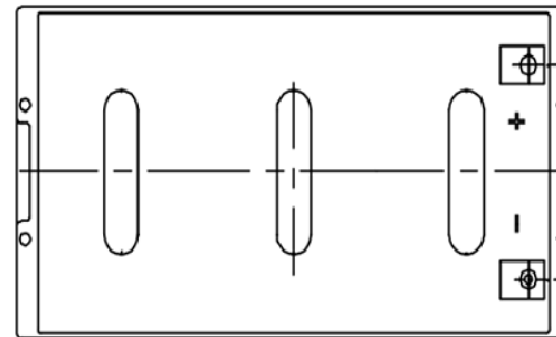
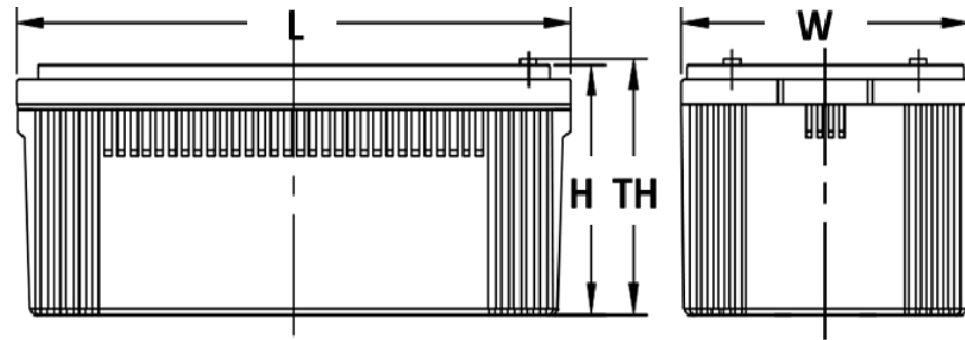

Sweep the attention





FUWEI

ENERGY

You can expect our batteries meet with the standards JIS, DIN, IEC60986-21/22 & BS6290-4.

Discharge Data

Discharge Constant Current (Amperes at 77°F /25°C)																									
End Point	5mi	10mi	15mi	20mi	25mi	30mi	35mi	40mi	45mi	50mi	55mi	1h	1.5h	2h	2.5h	3h	4h	5h	6h	7h	8h	9h	10h	12h	24h
1.60V	0	625	479	385	334	291	255	229	210	193	180	165	120	97.9	81.3	70.9	56.3	46.9	40.6	36.5	32.3	29.1	27.1	22.9	12.5
1.65V	0	586	451	364	314	274	243	218	200	184	173	158	116	93.8	78.1	68.1	54.6	45.3	39.6	35.3	31.6	28.6	26.3	22.3	12.4
1.70V	0	548	423	341	295	258	229	206	189	174	164	150	112	90.6	75	65.8	52.9	44.1	38.5	34.4	30.8	28.0	25.9	21.9	12.2
1.75V	0	509	394	319	275	241	216	194	179	164	154	143	106	86.3	72.5	63.5	51.1	43.0	37.5	33.6	30.0	27.5	25.4	21.6	12.1
1.80V	0	469	365	298	255	224	204	183	166	154	146	135	102	82.3	69.8	61	49.5	41.9	36.5	32.9	29.1	26.9	25.0	21.3	11.9
Discharge Constant Power per cell (Watts at 77°F /25°C)																									
End Point	5mi	10mi	15mi	20mi	25mi	30mi	35mi	40mi	45mi	50mi	55mi	1h	1.5h	2h	2.5h	3h	4h	5h	6h	7h	8h	9h	10h	12h	24h
1.60V	0	1115	856	690	598	521	459	413	380	349	329	303	224	185	154	135	109	92	80.8	71.5	64.3	58.1	53.3	45.0	25.3
1.65V	0	1053	810	654	565	494	438	394	363	334	315	291	216	179	149	131	106	89.8	78.8	70	62.9	57.1	52.5	44.5	24.9
1.70V	0	983	761	616	534	466	416	374	344	318	301	279	210	171	145	128	104	87.8	76.8	68.5	61.4	56.0	51.8	43.9	24.8
1.75V	0	916	715	580	501	439	395	355	326	303	286	266	203	165	140	123	101	85.5	74.8	67	59.8	55.0	51.0	43.4	24.4
1.80V	0	849	666	544	469	411	373	335	308	286	273	255	195	158	135	119	97.9	83.4	72.8	65.5	58.4	54.0	50.3	42.8	24.1

Note: The above characteristics data are average values obtained within three charge/discharge cycles not the minimum values.

All data shall be changed without notice. FUWEI reserves the right to explain and update the information contained hereinto.

Application

- UPS
- Telecom Systems
- Electric Wheelchair
- Power Station
- Military Equipment
- Emergency Power System
- Railway System

General Features

- Environmentally friendly
- Long Service Life, in Float and Cyclic
- Lower internal Resistance
- High Reliability and Good Quality
- International Standard, JIS and DIN
- lead-tin-calcium alloy grids for long service life
- Thick pasted plates with high quality





FUWEI

ENERGY

<http://www.fwny.net/en/>

6-CNJ-250

12V250Ah

