



CNJ-3000

2V3000Ah

Edition:2016.6
By Frank

FUWEI
ENERGY

<http://www.fwny.net/en/>

Component	Positive	Negative	Container	Cover	Safety Valve	Terminal	Separator	Electrolyte
Raw material	Lead dioxide	Lead	ABS	ABS	Rubber	Copper	AGM	GEL

To get the most out of your eco-friendly renewable energy system for home, RV or back-up power, you need a rugged, long-lasting solar photovoltaic (solar PV) battery from FUWEI energy. A high-capacity solar battery is perfect for backup systems, off-grid configurations and other applications that call for deep-cycle storage. Choose from absorbed glass mat (AGM) and gel-cell batteries for all your solar application needs.

Performance characteristics

Nominal Voltage 2V

Number of cell one

Nominal Capacity at 25 °C/77 °F

240Hr at 14.0 A to 1.9V-- 3360 Ah

100Hr at 32.7 A to 1.85V-- 3270 Ah

10Hr at 300 A to 1.8V-- 3000 Ah

Internal Resistance

Fully charged battery at 25 °C

≤ 0.5 mΩ

Average Self-discharge at 20 °C/68 °F

<3% lost of capacity per month

Operating Temperature range:

Discharge at -40~70 °C

Charge at -10~60 °C

Storage at -20~60 °C

Charge Methods constant voltage charge at 25 °C

Cycle use--2.4~2.45V/cell;

Maximum initial charging current 600 A

Temperature compensation

-5mV/cell/ °C

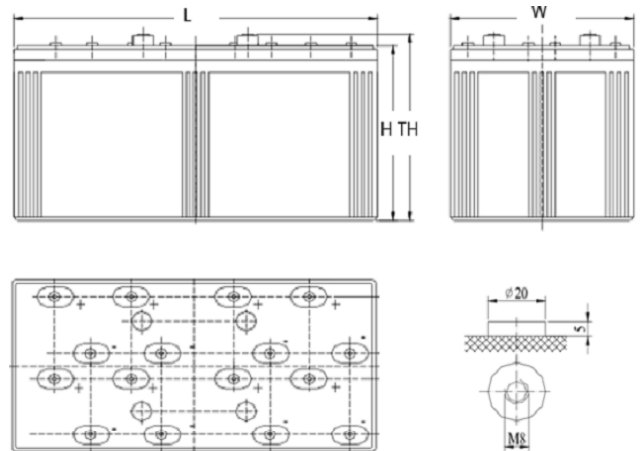

	mm/Kg	inch/lb
Length	705	27.8
Width	395	15.55
Height	347	13.7
TH	351	13.8
Weight	170.5	376
Terminal	F10	M8

JIANGSU FUWEI Energy CO.,LTD.

Quality Achievement Brand Build Our Future

Sweep the attention





CNJ-3000

2V3000Ah

FUWEI
ENERGY

<http://www.fwny.net/en/>

Constant Power discharge / WPC (25°C/77°F)

End voltage/cell	3 h	5 h	10 h	20 h	50 h	100 h	120 h	240 h
1.75V	1131	815	494	262	116	56.1	47.6	26.7
1.80V	1082	800	480	255	113	54.5	46.4	26.1
1.85V	1038	769	462	246	109	52.4	44.7	25.1
1.90V	997	741	446	237	106	50.6	43.1	24.4

Constant current discharge / A (25°C/77°F)

End voltage/cell	3 h	5 h	10 h	20 h	50 h	100 h	120 h	240 h
1.75V	754	543	309	164	68.1	35.000	29.800	15.700
1.80V	721	533	300	159	66.1	34.000	28.900	15.200
1.85V	692	512	288	153	63.5	32.700	27.700	14.600
1.90V	664	491.0	276	147	61.0	31.400	26.600	14.000

Note: The above characteristics data are average values obtained within three charge/discharge cycles not the minimum

All data shall be changed without notice. FUWEI reserves the right to explain and update the information contained hereinto



Application

- Telecom Systems
- Electric Wheelchair
- Solar System
- Marine Equipment
- Wind Power System
- Emergency Power System
- Wheelchair

General Features

- Environmentally friendly
- Long Service Life, in Cyclic
- Lower internal Resistance
- High Reliability and Good Quality
- International Standard, JIS and DIN
- High Power Density
- lead-tin-calcium alloy grids for long service life
- Thick pasted plates with high quality

JIANGSU FUWEI Energy CO.,LTD.

Quality Achievement Brand Build Our Future



CNJ-3000

2V3000Ah

FUWEI

ENERGY

<http://www.fwny.net/en/>

